



MOKO SMART

Wayfinding solution Condition monitoring

L01 Location Anchor



The L01 Location Anchor, a BLE technology based and impressive battery life beacon, is ideal for wayfinding solution, proximity marketing and asset tracking in hospital, shopping mall and warehouse.

Not only providing location-based infrastructure, it can be also integrated with temperature, humidity and barometer sensor through its hardware compatible design, to realize condition monitoring and offer comprehensive application scenarios.

What Impressed

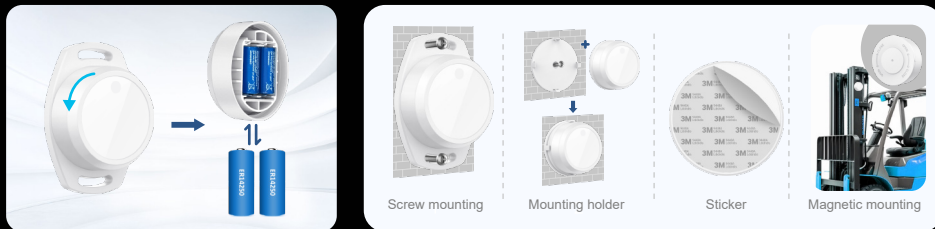

Rotating replaceable battery

Multiple adaptive installation

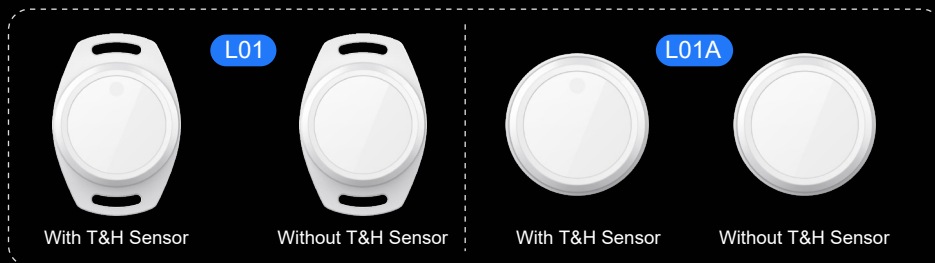

With T&H Sensor

Without T&H Sensor

With T&H Sensor

Without T&H Sensor



IP67 waterproof



High accuracy sensing



Historical data storage



Rotating replaceable battery



All-in-one sensor integration

General Specs

Connectivity:	BLE 5.1
Dimensions:	76.2*53.6*24.0mm (L01) Φ54.5*24.0mm (L01A)
Color:	Gray
Material:	PC
IP rating:	IP67
Sensor:	Temperature&Humidity sensor Hall effect sensor* Accelerometer sensor Barometric pressure sensor

Battery capacity:	2400mAh replaceable battery
Flash memory:	2M Bytes
Battery lifespan:	8+ years*
Operating temperature:	-20°C to 60°C (Can be extended to -40°C~80°C)
Transmission range:	Up to 150m (Without any obstacles)
Installation:	Sticker Screw Zip Tie Magnet
Certification:	FCC CE RoHS REACH

Sensor Specs

Temperature & Humidity sensor	
Accuracy tolerance:	±0.5°C(condition: 0°C - 60°C) ±2% RH(condition: 20% - 80% RH)
Resolution:	0.1°C 0.1% RH
History storage:	60000 groups

Barometric Pressure Sensor

Pressure measurement range	30kPa - 125kPa
Relative pressure accuracy	±6Pa

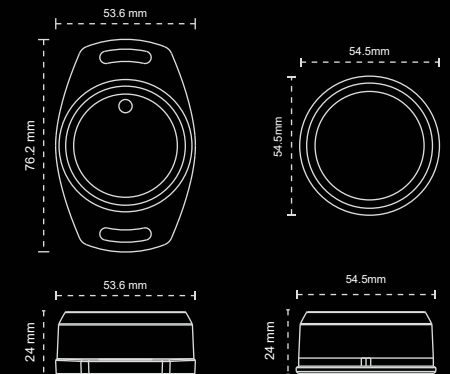

*Lifespan estimated based on standard asset tracking scenario under 25°C conditions. (0dBm Tx Power | 1000ms ADV interval | 5mins temperature recording interval)

*Hall switch is not applicable for the magnetic mounting version.